**Refit**

1. Clean bush and bush location in lower arm.

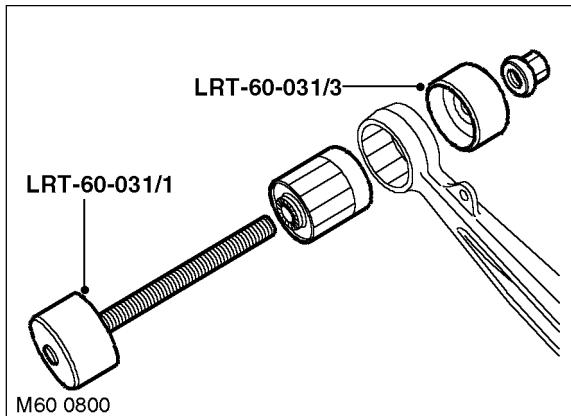

2. Using LRT-60-031/1 and LRT-60-031/3 fit bush to lower arm.
3. Position lower arm and align to subframe fit new bolt but do not tighten at this stage.  
**CAUTION: Nuts and bolts must be tightened with weight of vehicle on suspension.**
4. Connect height sensor link to lower arm, fit nut and tighten to 8 Nm (6 lbf.ft).  
**CAUTION: Ensure height sensor arm is pointing outwards.**
5. Fit road wheel and tighten nuts to 140 Nm (103 lbf.ft).
6. Remove stand(s) and lower vehicle.
7. Tighten bolt securing lower arm to subframe to 165 Nm (121 lbf.ft) plus a further 90°.
8. Repeat procedure for other side.
9. Check front wheel alignment.

**Height sensor**
**60.36.01**

For models fitted with Xenon headlamps, the RH front and RH rear height sensors are different to those models with standard headlamps. The Xenon sensors can be identified by a white stripe on the back face of the sensor housing. These sensors can be fitted to models without Xenon headlamps. The sensors fitted to models without Xenon headlamps cannot be fitted to those with Xenon headlamps.

**Remove**

1. Raise front of vehicle.

**WARNING: Do not work on or under a vehicle supported only by a jack. Always support the vehicle on safety stands.**

2. Remove road wheel.

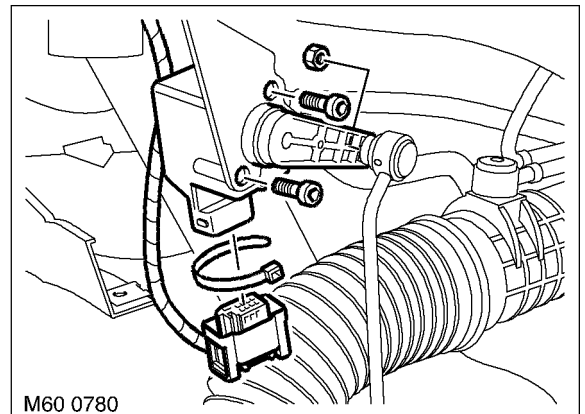

3. Remove cable tie and disconnect multiplug.
4. Remove nut and disconnect link from sensor.  
**CAUTION: Use an open ended spanner on flats provided to prevent ball joint rotating.**
5. Using a 4mm Allen socket, remove 2 Allen screws securing height sensor to mounting bracket and remove height sensor.

# FRONT SUSPENSION

## Refit

1. Ensure sensor and mounting bracket mating surfaces are clean.
2. Position height sensor to mounting bracket, fit Allen screws and tighten to 5 Nm (3.7 lbf.ft).
3. Connect link to height sensor, fit nut and tighten to 8 Nm (6 lbf.ft).

**CAUTION: Ensure height sensor arm is pointing outwards.**

4. Connect multiplug and secure harness with cable tie, taking care not to exert excessive tension on wires as they enter multiplug.

**CAUTION: Ensure 'O' ring seal is correctly located in multiplug.**

5. Fit road wheel and tighten nuts to 140 Nm (103 lbf.ft).
6. Remove stands and lower vehicle.
7. If a replacement sensor has been fitted, use TestBook/T4 to re-calibrate system.

 **FRONT SUSPENSION, ADJUSTMENTS, Calibrate - air suspension.**

## Tie rod

 **60.40.09**

## Remove

1. Raise front of vehicle.

**WARNING: Do not work on or under a vehicle supported only by a jack. Always support the vehicle on safety stands.**

2. Remove road wheel.

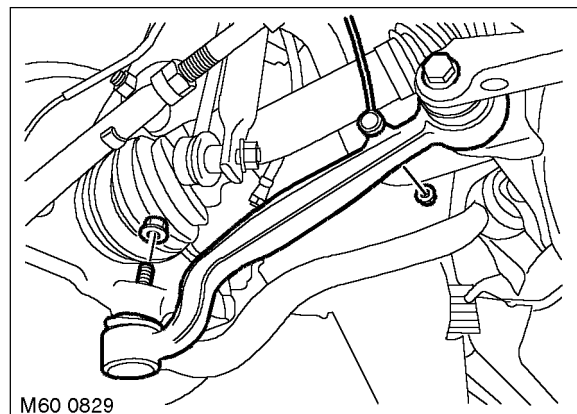

3. Remove nut securing height sensor link to lower arm and release link.
4. Loosen bolt securing lower arm to subframe one quarter of a turn.
5. Remove nut securing ball joint to lower arm.

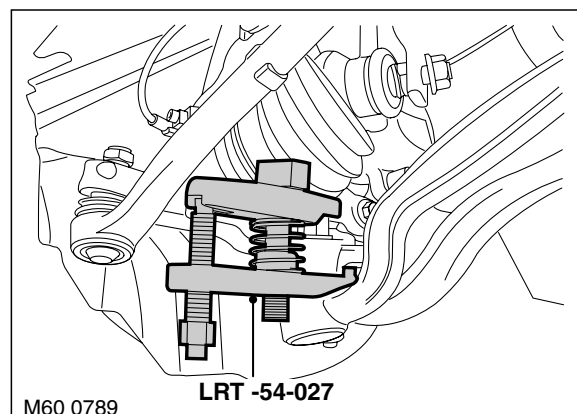

6. Using **LRT-54-027** release lower arm ball joint and disconnect lower arm from hub.

**CAUTION: Ensure ball joint seal is not damaged. A damaged seal will lead to premature failure of the joint.**